

Installation Instructions

Honeycomb Shades

Cordless & Cordless TDBU for Woven Colors

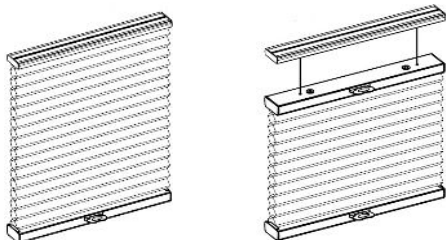

Getting Started

Remove shade from package. Save packaging until shade is installed and working to your satisfaction.

Tools:

- Level
- Measuring Tape
- Pencil
- Power drill
- (1/4" hex driver and drill bit)
- Screwdriver



You will need to use the following fasteners for your particular mounting surface.

Surface	Fastener
Wood	#8 1 1/4" Screws (Provided) #6 3/4" screws
Drywall/Plaster	Wall Anchors, Expansion Bolts (Not Provided)
Metal	Sheet Metal Screws (Not Provided)

Check Components/Hardware:



Installation Bracket
(3/4" Single)

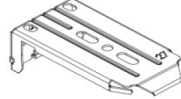

Installation Bracket
(1 1/4" Single)



Handle



Hold Down bracket
(Optional)

Hardware Standard Quantity

For Cordless:

Order Width (X)	X ≤ 39"	39" < X ≤ 66"	66" < X ≤ 86"
Installation Bracket	2	3	4
Handle	1pc for X ≤ 72" 2pcs for X > 72"		
1 1/4" Screw for Installation Bracket	4	6	8
Hold Down Bracket (Optional)	2	2	2
Spacer Block (Optional)	1pc to extend distance 3/8" 2pcs to extend distance 11/16"		
2" Screw for Installation Bracket with Spacer Block (Optional)	4	6	8
3/4" Screw for Hold Down Bracket (Optional)	2	2	2

For Cordless TDBU:

Order Width (X)	X ≤ 39"	39" < X ≤ 66"	66" < X ≤ 78"
Installation Bracket	2	3	4
Handle	2pcs for X ≤ 72" 4pcs for X > 72"		
1 1/4" Screw for Installation Bracket	4	6	8
Hold Down Bracket (Optional)	2	2	2
Spacer Block (Optional)	1pc for extend distance 3/8" 2pcs for extend distance 11/16"		
2" Screw for Installation Bracket with Spacer Block (Optional)	4	6	8
3/4" Screw for Hold Down Bracket (Optional)	2	2	2

Note: Optional flat head screws included.
Use as needed.

Step 1: Bracket Installation

- Measure 5" from both ends of the headrail. Mark the bracket location on the mounting surface.

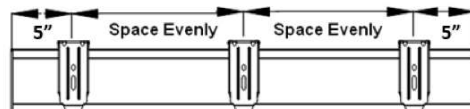

Inside Mount:

Use two 1 1/4" mounting screws to secure brackets.
Use wall anchors for drywall or plaster wall.

Place brackets and align with the wall.

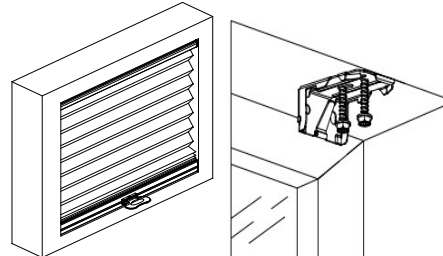

Outside Mount:

Use two 1 1/4" mounting screws to secure brackets.
Use wall anchors for drywall or plaster wall.

Allocate a min. distance of 3/16" between the end of the brackets and the top of the window frame.

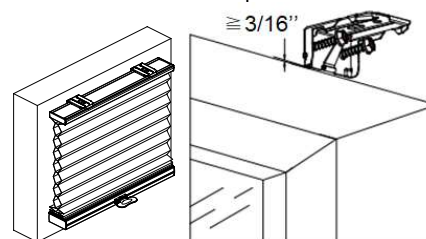

* For shallow mounting, use a flat head screw to secure the bracket at 45°.

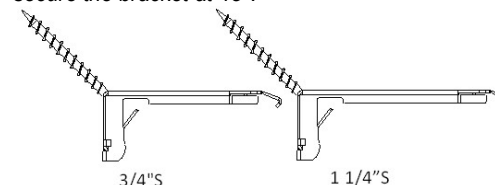

Step 2: Shade Installation

- Position the headrail at an angle so that it hooks into the front of the bracket. Then push upward to snap the headrail into the bracket.

▲ For proper installation, start by attaching the front of the rail to the bracket and ensure to stick right in place.

• Note: You will hear a click sound once the head rail is properly secured..

- For easier installation, lower the middle rail of cordless TDBU away from the headrail before installing the headrail.

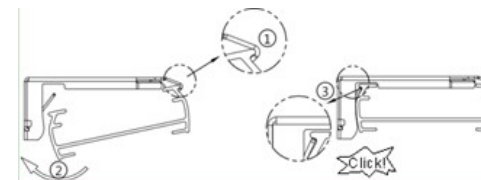

Step 3: How to Install Shade Handle

Hook the top part of the handle onto the rail rib. Push the handle downward so it clips to the bottom of the rail. You will hear a loud click sound once the handle is properly secured.

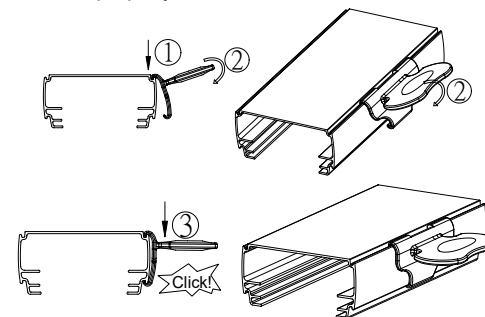

▲ For order width > 72", the distance between the 2 handles should be 48" as below.

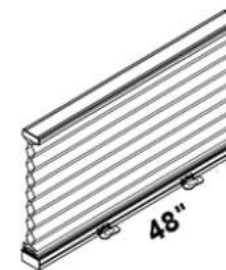

★ Congratulations! You have finished installing the shade.

How to Uninstall Shade Handle

Use a flat head screwdriver to remove the handle from the bottom of the rail.
(To avoid scratching the rail with the screwdriver, please put a piece of adhesive tape on the head of the screwdriver before removing the handle from the rail.)

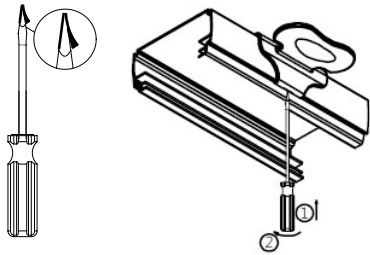

Shade Operation

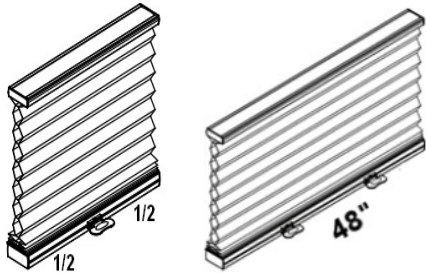

To lower the shade, gently pull down the shade by the bottom rail handle and stop at the desired location.
For TDBU, pull down the bottom rail first before lowering the middle rail.

To raise the shade, gently raise the shade by the bottom rail handle to desired height.

For TDBU, if the shade will not lift, pull the middle rail down fully to the bottom first and then raise up bottom rail together with middle rail.

⚠ Do not grasp the rail unevenly. Always lower or raise the shade in the middle, or use even pressure with both hands to operate both handles on the rail.

How to Install Hold Down (optional)

A. For Hold Down Brackets

Use #6 3/4" screw to secure each bracket. Please fasten the screw tightly.

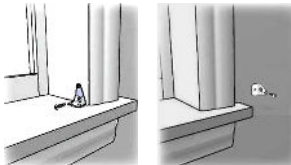

B. For Magnetic Hold Down

Use M3x15mm screw to secure the magnet catch at the below location. Make sure the magnet catch aligns with the pre-installed magnet on shade bottom rail.

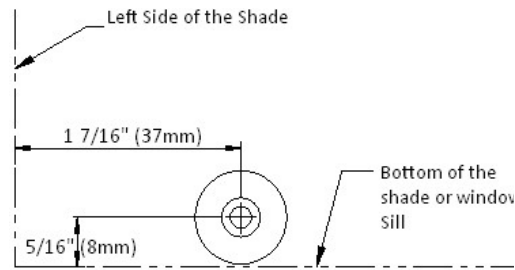

Shade Removal

For cordless, fully raise the shade.
 For TDBU, lower the middle rail.
 Gently pry the bracket off the headrail with a flat screwdriver as pictured below.
 Remove the shade.

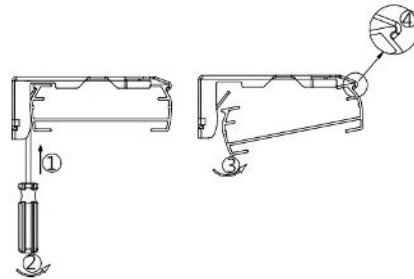

Cleaning the Shade

Routine cleaning will help maintain the beauty of your shade. The shade can be cleaned by using a soft brush, vacuumed with a low suction hand-held vacuum, cleaned ultrasonically (specify that a mild solution must be used and that the headrail should never be immersed in liquid). Spot cleaning is not recommended, but if necessary, dampen a clean cloth with a solution of warm water and mild detergent to dab the spot until it's gone (do not rub!).

Troubleshooting

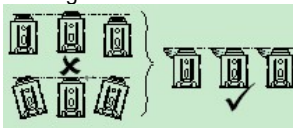
Problem	Solution
The shade will not snap into the mounting brackets.	Check if mounting brackets are aligned. Refer to below drawing. 
The shade will not lift.	Gently pull down on the bottom rail to reactivate the cordless mechanism. Repeat if necessary. For TDBU, pull the middle rail

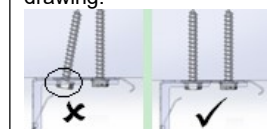
Problem	Solution
	down fully to the bottom first. Then raise the bottom rail and middle rail up together. Check if all brackets are locked in place. Refer to below drawing. 
The shade stacks up unevenly.	Lower the shade completely, and then raise it up to correct it. Repeat if necessary.
For Woven fabrics, repeated rubbing or where it comes into contact with the window edge may cause the fabric edges to fray slightly over time.	To remedy, use a pair of fabric scissors to gently trim the fraying.

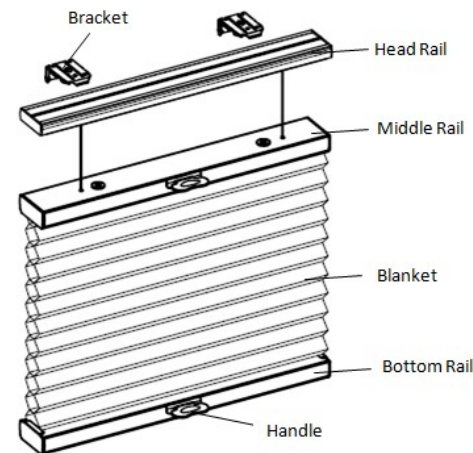

Some options listed may not be applicable.

Optional Parts Installation

Side Mount Bracket

Side mount bracket is only available for the arch window with shade width $\leq 37"$ and the normal bracket qty should be 2.



Hardware Standard Quantity

Shade Width (X)	$X \leq 37"$
Installation Bracket	2
1 1/4" Screw for Installation Bracket	4
Side Mount Supporting Bracket	2
M4 Nut & Bolt	2 sets

How to assemble side mount bracket

Align the side mount supporting bracket holes with the installation bracket holes, and then screw the M4 nut & bolt into the diagonal holes for the left side mount bracket. Do the same for the right side mount bracket.

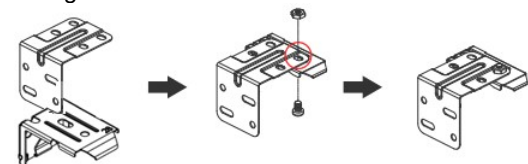

How to install side mount bracket

Put two 1 1/4" mounting screws into the diagonal holes to secure bracket. Use

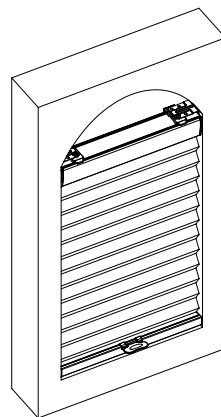
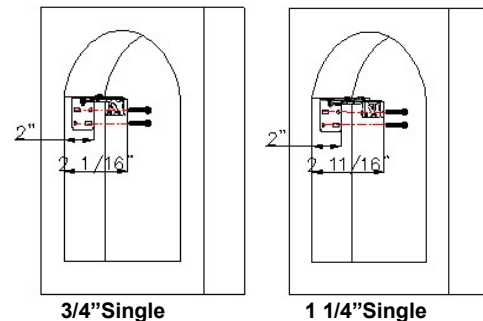

Light Guard

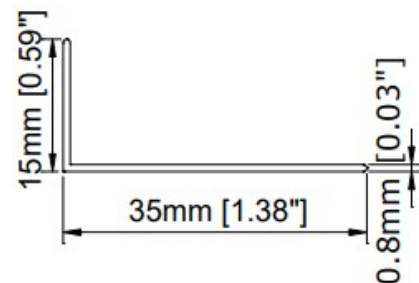

Light Guard



3/4" (M3.5x18.5mm) Flat Head Screw



Clear Plastic Tape (only for split light guard)

Install Light Guard (optional for IB)

Notice: To avoid scraping, leave at least 1/16" (2mm) gap between fabric stack and light guard.

The light guard is to be placed at back of the shade on left & right side.

- A. When the light guard length $\leq 96"$, place the light guard vertically towards the bottom window frame and then mark out the location with a pencil. Remove the

double sided tapes and carefully paste the light guard in position. Fix 2pcs of 3/4" flat head screws to secure the light guard.

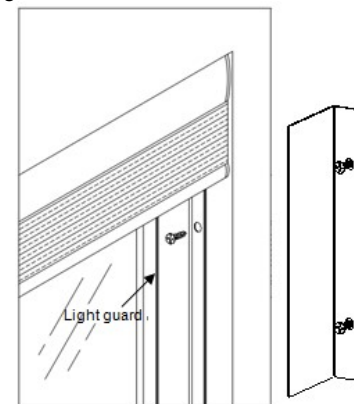

Note: The light guards on both sides are identical;

Use the double-sided tape on the narrow side of the light guard to attach to the window frame.

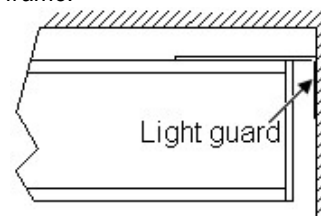

- B. When the light guard length exceeds 96", it will be spliced into 2pcs. Stick 2pcs of clear plastic tapes on both sides of the split part to seam the light guard. Place the light guard vertically towards the bottom window frame and then mark out the location with a pencil. Remove the double sided tapes and carefully paste the light guard in position. Fix 4pcs of 3/4" flat head screws to secure the light guard.

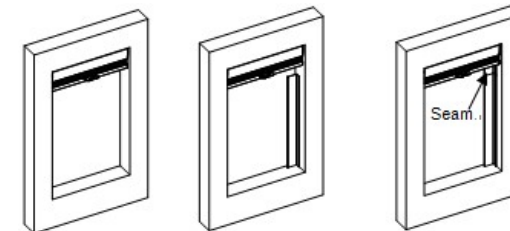
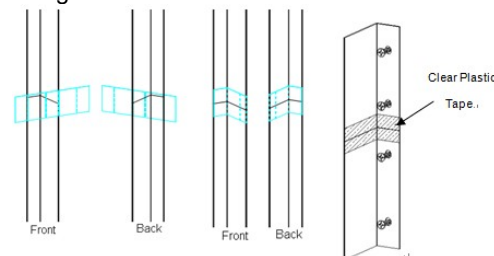

Note: We recommend that the seam be placed on top, shown in above drawings.